

HR911442BE

Electrical Specification @25°C

Isolation:	2250VDC Min.	0.5mA 60sec (J1~8 to P1~6 & J1~8 to P11~14 & J1~8 to Shield)
OCL:	350uH Min.	@100KHz 100mV with 8mADC
Turns Ratio: (P1-P2) : (J1-J2) =	1CT:1CT ±2%	
Turns Ratio: (P5-P6) : (J3-J6) =	1CT:1CT ±2%	
Insertion Loss:	-1.2dB Max.	@1MHz ~ 100MHz
Return Loss:	-18dB Min.	@1MHz ~ 30MHz
Return Loss:	-14dB Min.	@30MHz ~ 60MHz
Return Loss:	-12dB Min.	@60MHz ~ 80MHz
Common Mode Rejection:	-30dB Min.	@1MHz ~ 100MHz
Crosstalk:	-30dB Min.	@1MHz ~ 100MHz
PoE current	720mA Max.	@57VDC using VC1 channel or VC2 channel

Schematics

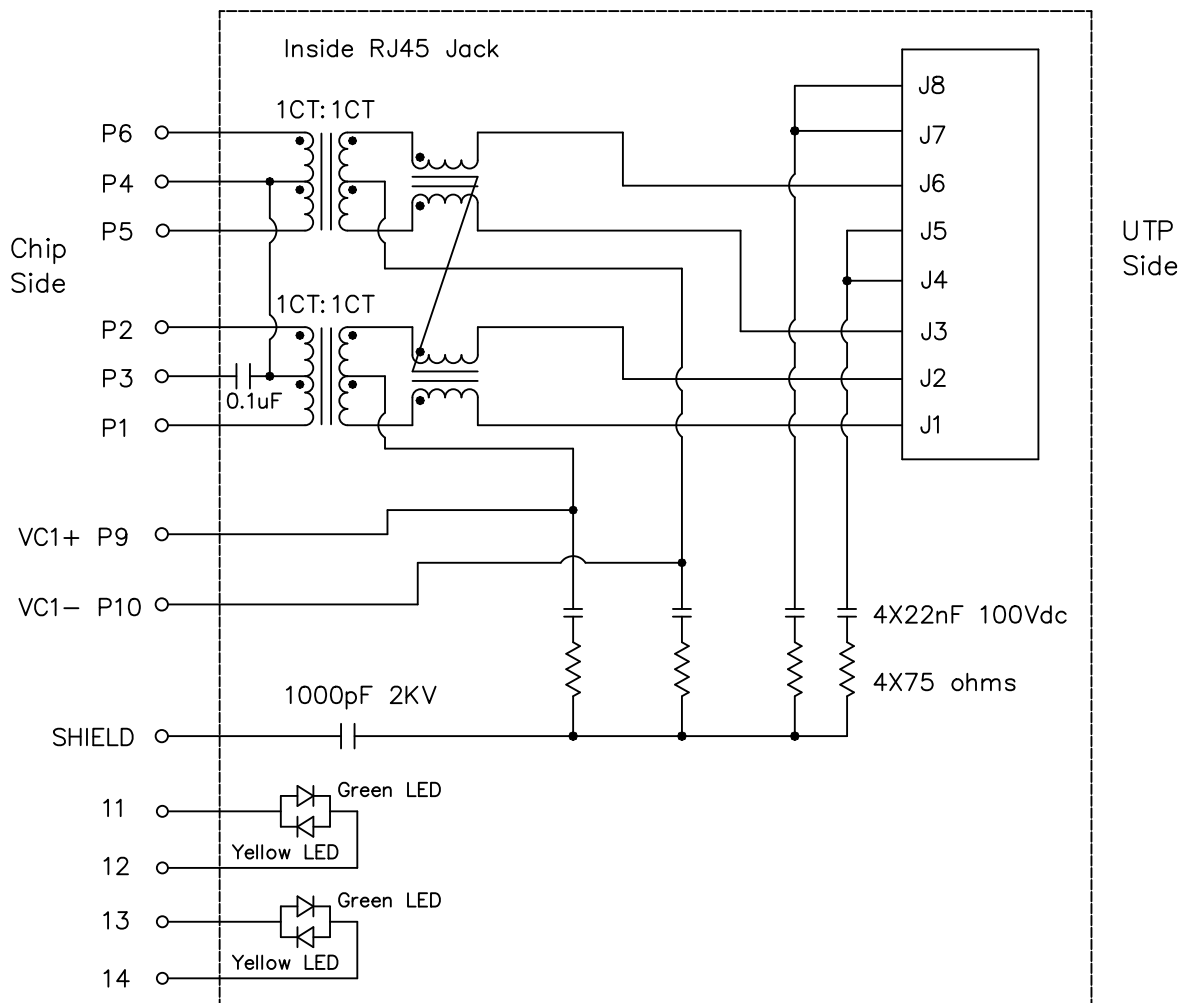

Notes: Connect CHS GND to PCB Ground

HR911442BE

- RoHS Compliant (PB Free)
- High performance for EMI suppression, Crosstalk, Return Loss and Consistent Electrical
- Minimum 2250VDC isolation per IEEE802.3 requirement
- Minimize PCB space and Simplify PCB Layout
- Less magnetic components to be placed on PCB, higher reliability and yields
- UL Recognized Component: File # E330599

Mechanical Dimensions



(Top View)

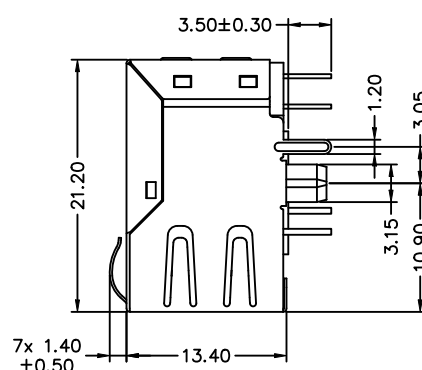

(Side View)

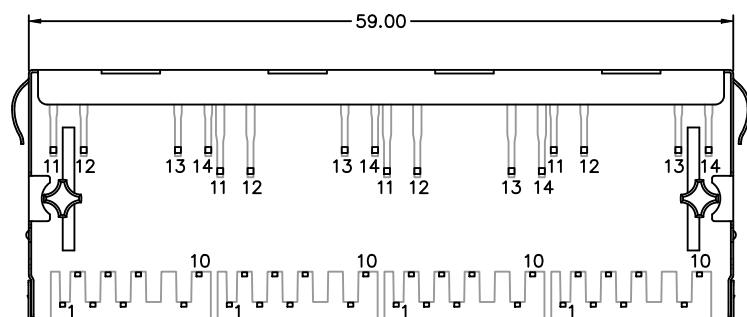

(Bottom View)

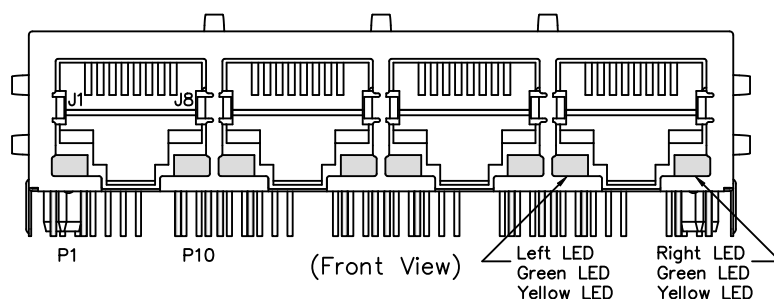

(Front View)

Remark:

1.Remove Pin#7,#8

Standard LED	Wavelength	Forward V (Min/Max)	Forward A	Type
Green/Yellow	568nm/585nm	1.8V/2.8V	20mA	squareness

Dimensions in mm

Unless otherwise specified, Tolerance: .xx ±0.25

REV.: A6

2 of 4

DRAWN:

CHECK:

APPROVAL:

Tel: (0760)86103511 86103508 Fax: (0760)86103686 Post code: 528416

E-Mail: sales@hanrun.com <http://www.hanrun.com>

PCB Layout

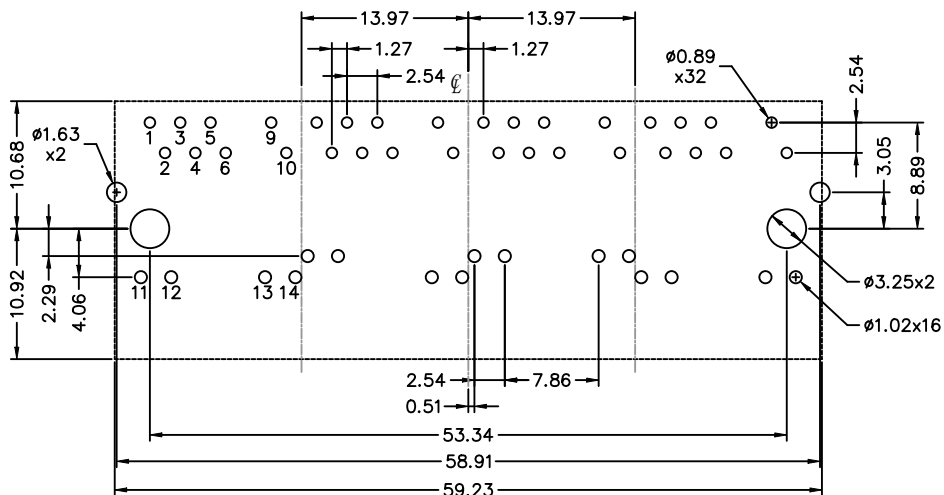

All dimension tolerance are ± 0.08 unless otherwise specified

Technical drawing of the PCB assembly showing top and side views with dimensions:

- Top view dimensions:
 - Length: 59.70 ± 0.13
 - Width: 14.20 ± 0.13
- Labels:
 - PANEL
 - PCB
- Side view dimension:
 - Thickness: 2.03

REV.: A6

APPROVAL:

E-Mail: sales@hanrun.com <http://www.hanrun.com>

HR911442BE

Material Specification

Housing: PA66 GF Black UL94V-0
Shield: 30u" Nickel over 0.20mm Thickness Brass
Insert: PA66 GF Black UL94V-0
Phosphor Bronze 0.35mm Thickness
Plating Area, 30u" gold over 50u" nickel
Solder Area, 100u" tin over 50u" nickel

Mechanical Performance:

Mating force: 5 lbs Maximum
Unmating force: 5 lbs Maximum
Plug to Jack Retention force: 20 lbs Minimum
Operating life: 750 Cycles Minimum

Operating and Storage Temperature:

Operating Temperature Range: -40°C ~ +95°C
Storage Temperature Range: -40°C ~ +95°C