

HR911080A

Electrical Specification @25°C

RoHS Compliant (PB Free)

Operating Temperature Range: 0°C ~ +70°C

Isolation: 1500Vrms or 2250Vdc 0.5mA 60sec (J1~8 to P1~12)

OCL: 120uH Minimum @100KHz 100mV

Insertion Loss: -3.0dB Maximum @100KHz / -2.0dB Maximum @1MHz ~ 400MHz

Return Loss: -18dB Minimum @1MHz ~ 40MHz / -13dB Minimum @40MHz ~ 100MHz

-10dB Minimum @100MHz ~ 200MHz / -8.3dB Minimum @200MHz ~ 300MHz

-7dB Minimum @300MHz ~ 400MHz / -6dB Minimum @400MHz ~ 500MHz

Common Mode Rejection Ratio: -35dB Minimum @1MHz ~ 100MHz

-30dB Minimum @100MHz ~ 300MHz / -25dB Minimum @300MHz ~ 500MHz

CDMR: -30dB Minimum @1MHz ~ 250MHz / -22dB Minimum @250MHz ~ 500MHz

Crosstalk: -28dB Minimum @1MHz ~ 100MHz / -19dB Minimum @100MHz ~ 500MHz

Schematics

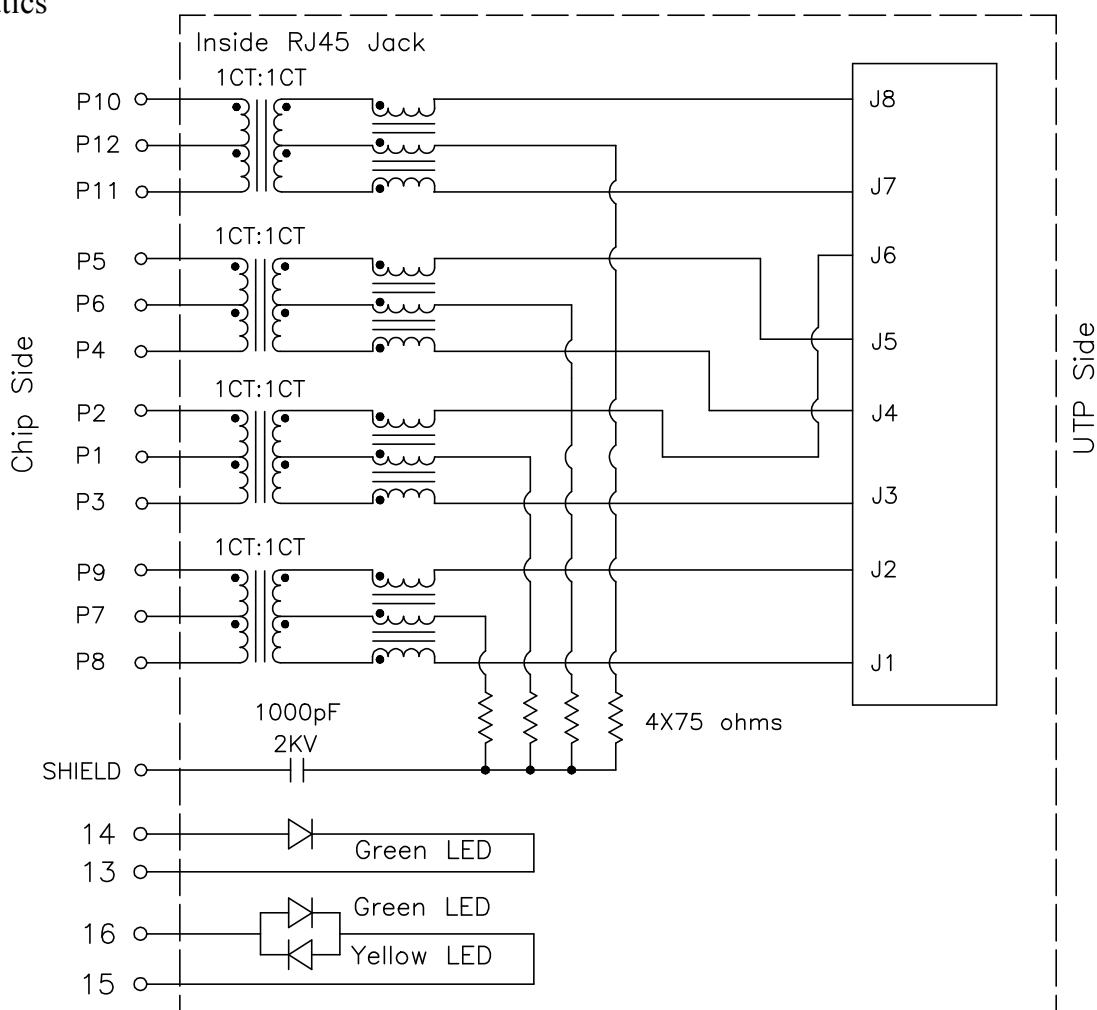

HR911080A

- RoHS Compliant (Pb Free)
- Sing port Tab-UP with internal magnetics for 10GBase-T
- Meets or Exceeds IEEE802.3an standards
- High performance for EMI suppression, Crosstalk, Return Loss and Consistent Electrical
- Minimum 1500Vrms isolation per IEEE802.3 requirement
- UL Recognized Component: File # E330599

Mechanical Dimensions:

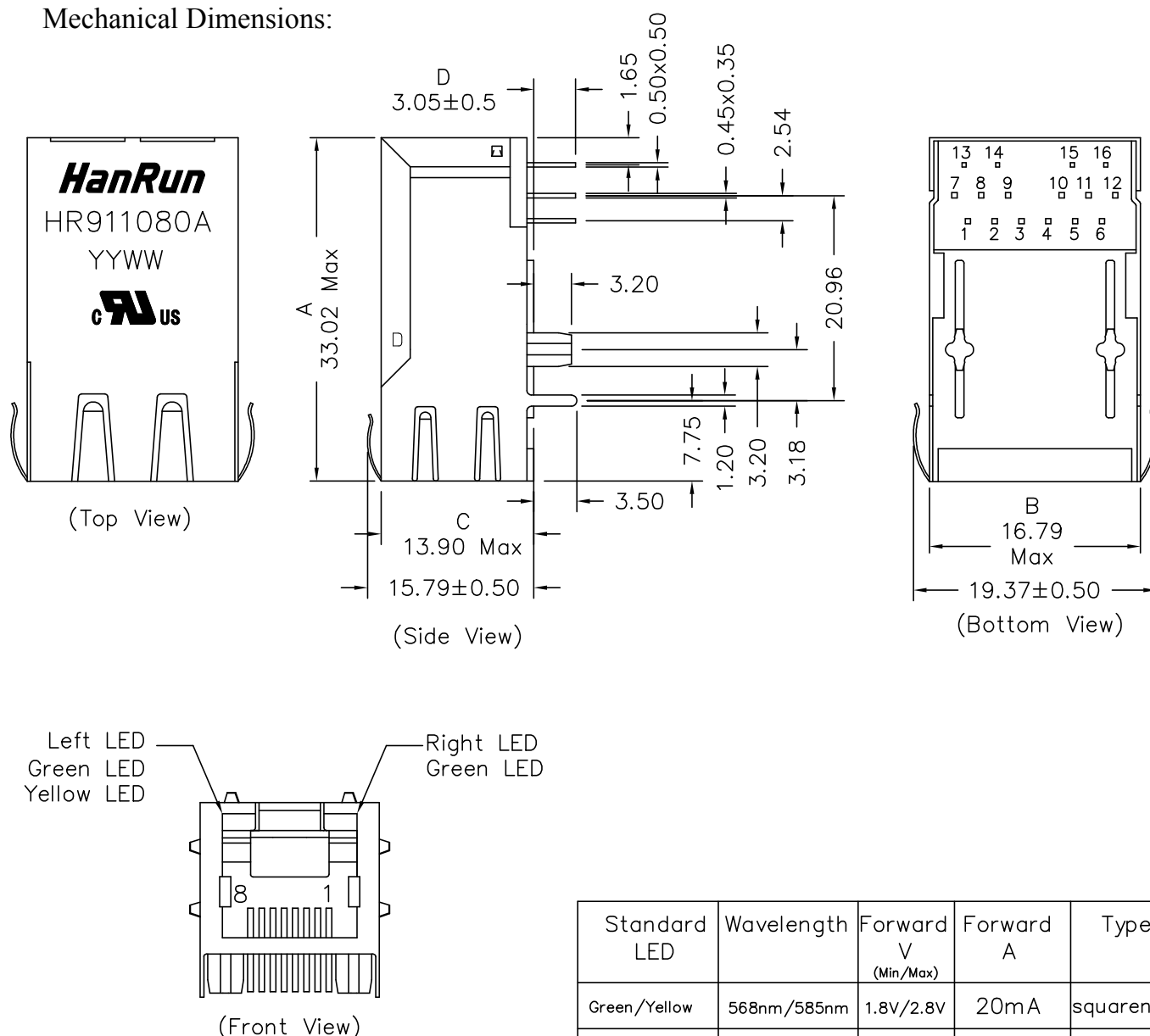

Dimensions in mm

Unless otherwise specified, Tolerance: .xx ±0.25

REV.: 02

2 of 3

PCB Layout:

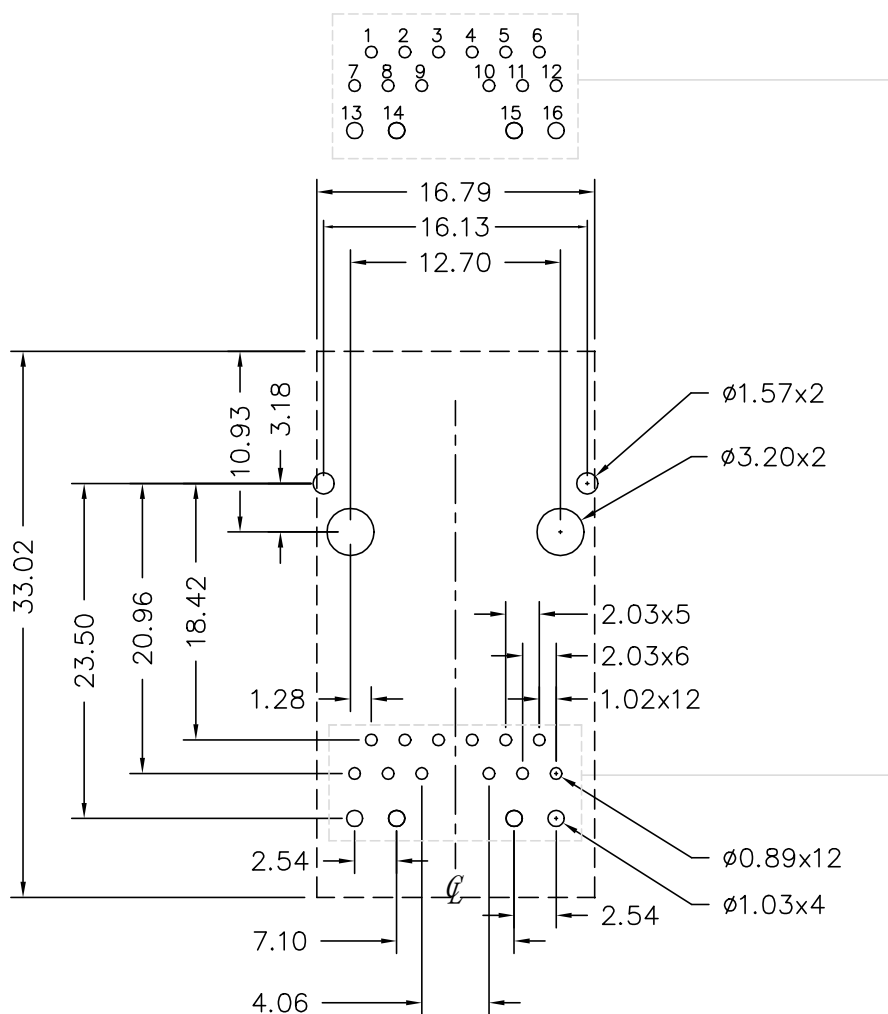

All dimension tolerance are ± 0.08 unless otherwise specified

3 of 3