

HR971473CE

Electrical Specification @25°C

RoHS Compliant (PB Free)

Operating Temperature Range: -40°C ~ +85°C

Isolation: 2250VDC 0.5mA 1minute (UTP Side to Chip Side)

OCL: 350uH Minimum @100KHz 100mV with 8mADC

Insertion Loss: -1.0dB Maximum @1MHz ~ 100MHz / -1.5dB Maximum @100MHz ~ 125MHz

Return Loss: -18dB Minimum @1MHz ~ 30MHz / -15dB Minimum @40MHz

-13.1dB Minimum @50MHz / -12dB Minimum @60MHz ~ 80MHz

-10dB Minimum @100MHz

Different to Common Mode Rejection: -40dB Minimum @30MHz / -33dB Minimum @80MHz

-30dB Minimum @100MHz

CMRR: -30dB Minimum @1MHz ~ 100MHz

Crosstalk: -35dB Minimum @30MHz / -30dB Minimum @60MHz

-25dB Minimum @100MHz

Schematics

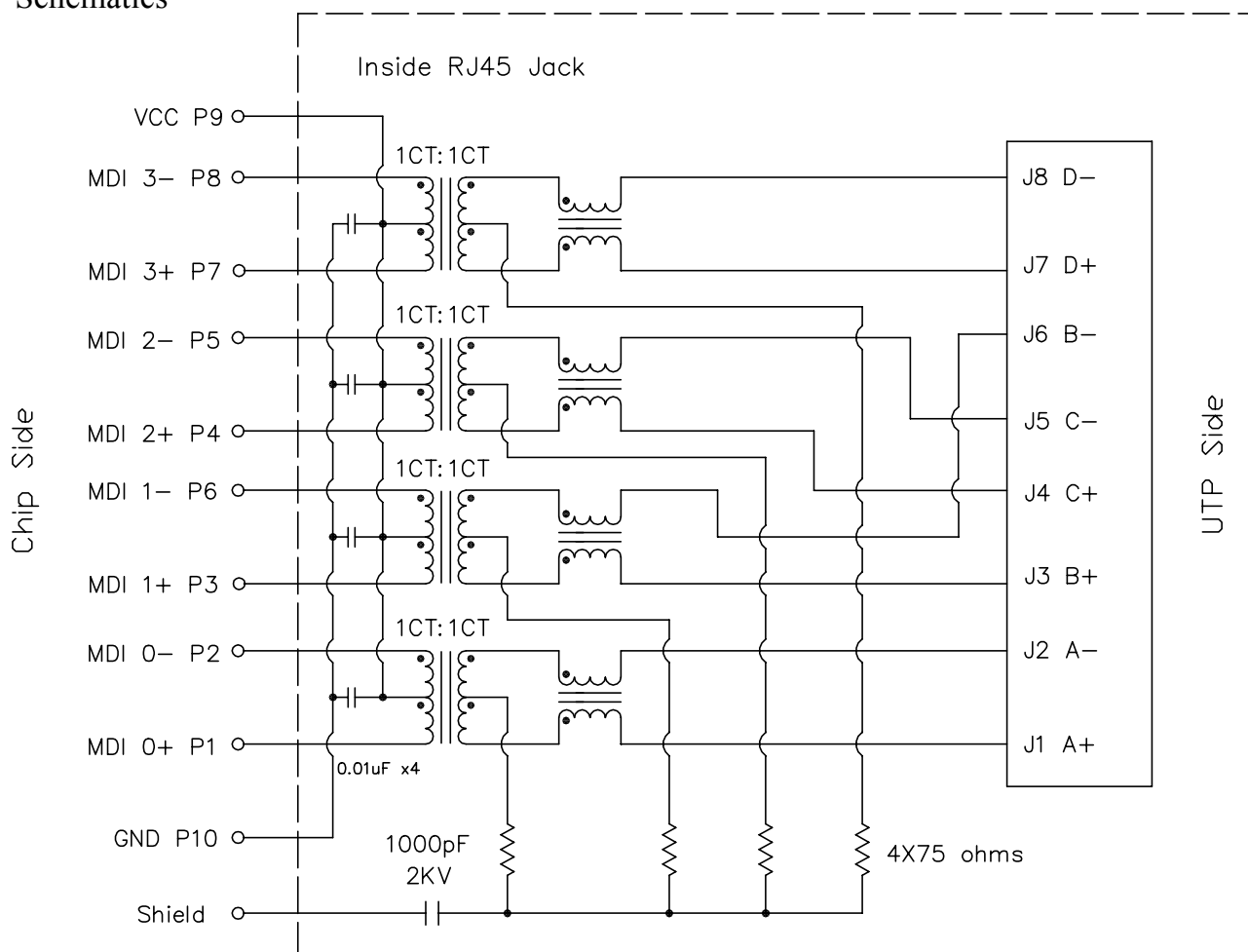

HR971473CE

- Designed for Network Interface Card Application
- Meets or Exceeds IEEE802.3ab standards including 350uH Min OCL with 8mADC
- High performance for EMI suppression, Crosstalk, Return Loss and Consistent Electrical
- Minimum 2250VDC isolation per IEEE802.3 requirement
- Minimize PCB space and Simplify PCB Layout
- Less magnetic components to place on PCB, Higher reliability and yields
- UL Recognized Component: File # E330599

Mechanical Dimensions:

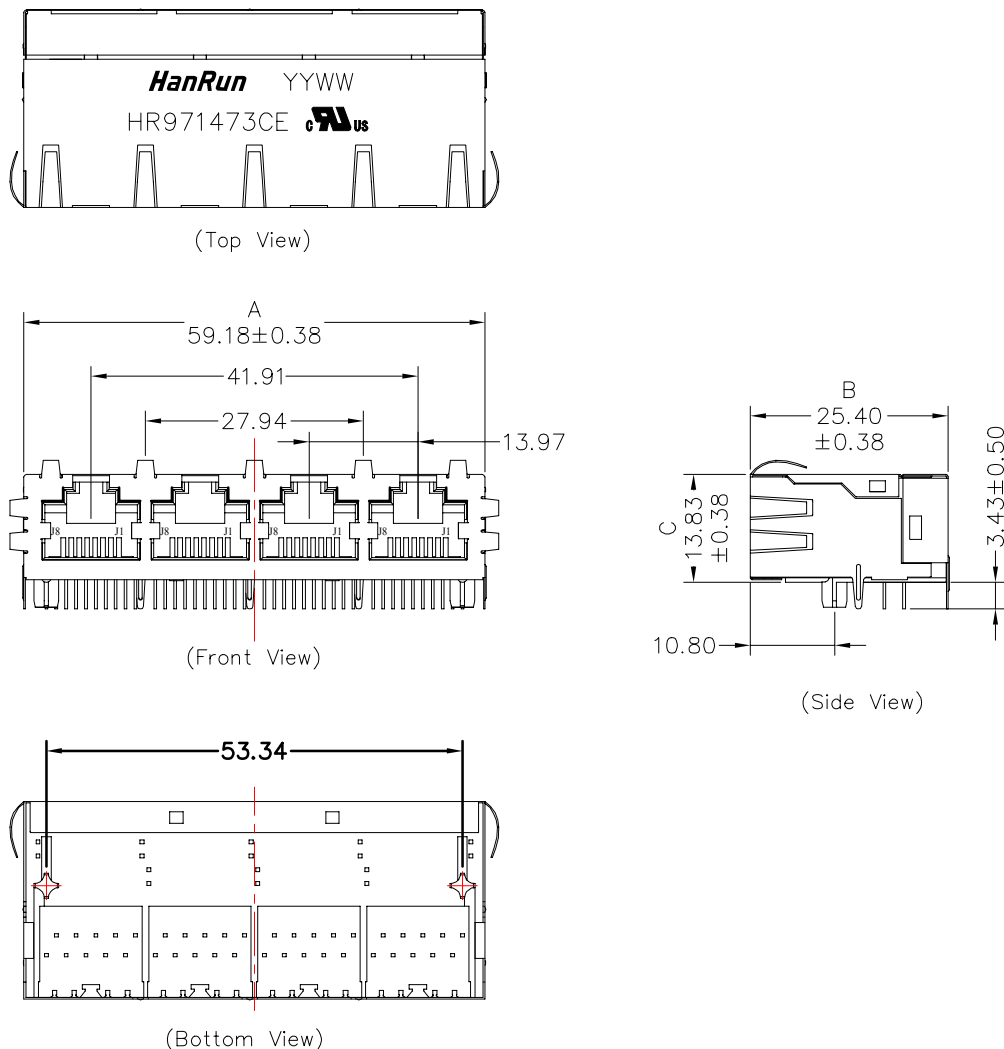

Dimensions in mm

Unless otherwise specified, Tolerance: .xx ±0.25

REV.: 01

2 of 4

HR971473CE

PCB Layout:

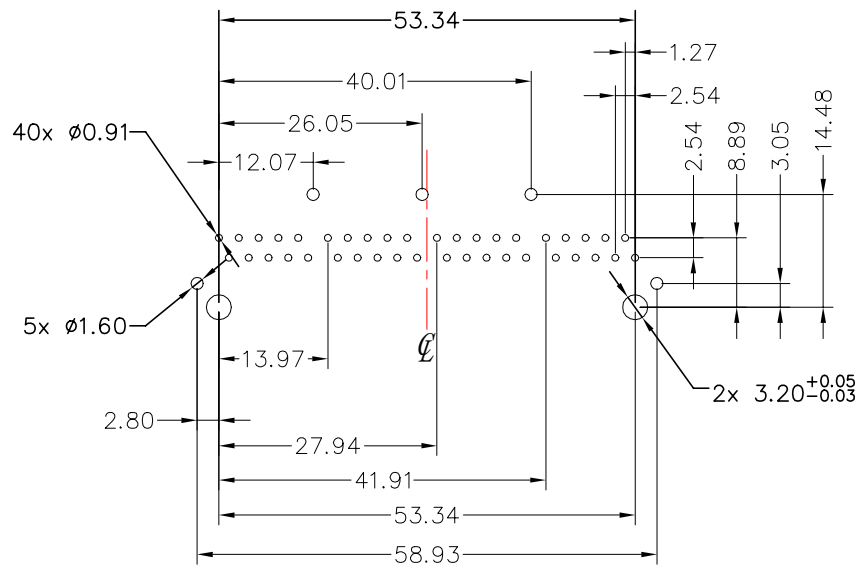

Recommended PCB layout (Component Side View)

All dimension tolerance are ± 0.08 unless otherwise specified

Pin Assignments:

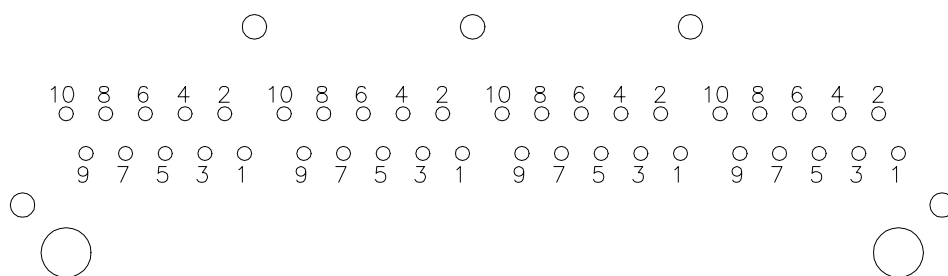

Dimensions in mm

Unless otherwise specified, Tolerance: .xx ± 0.25

REV.: 01

3 of 4

HR971473CE

Suggested Panel Cutout

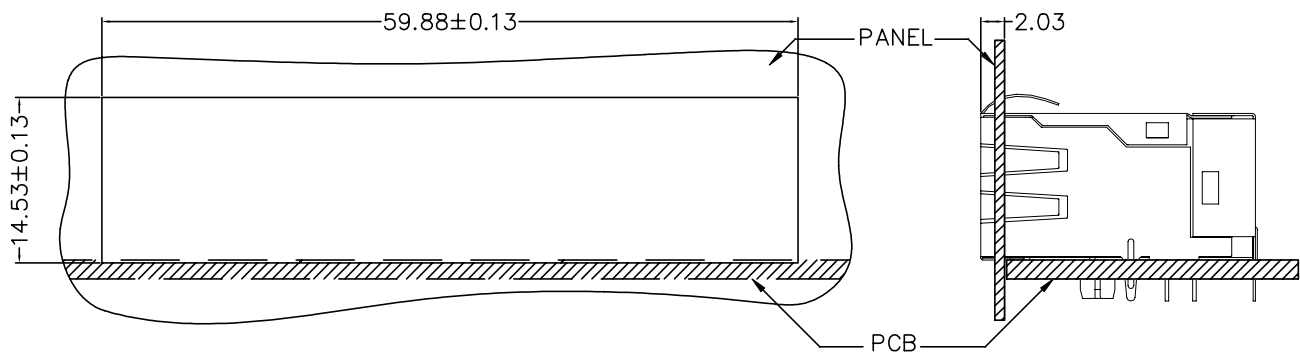

Dimensions in mm

Unless otherwise specified, Tolerance: .xx ±0.25

REV.: 01

4 of 4