

1x1 Port Tab-UP RJ45 Connector
With integrated magnetics and LED
For 10/100Base-T applications
Is suitable for reflow solder mounting

HR915592AE

Electrical Specification @25°C

Isolation:	2250VDC Min.	0.5mA 60sec UTP Side to Chip Side
OCL:	350uH Min.	@100KHz 100mV with 8mADC
Insertion Loss:	-1.0dB Max.	@1MHz ~ 100MHz
Return Loss:	-18dB Min.	@1MHz ~ 30MHz
Return Loss:	-14dB Min.	@30MHz ~ 60MHz
Return Loss:	-12dB Min.	@60MHz ~ 80MHz
Return Loss:	-10dB Min.	@80MHz ~ 100MHz
Common Mode Rejection:	-30dB Min.	@1MHz ~ 100MHz
Crosstalk:	-30dB Min.	@1MHz ~ 100MHz

Schematics

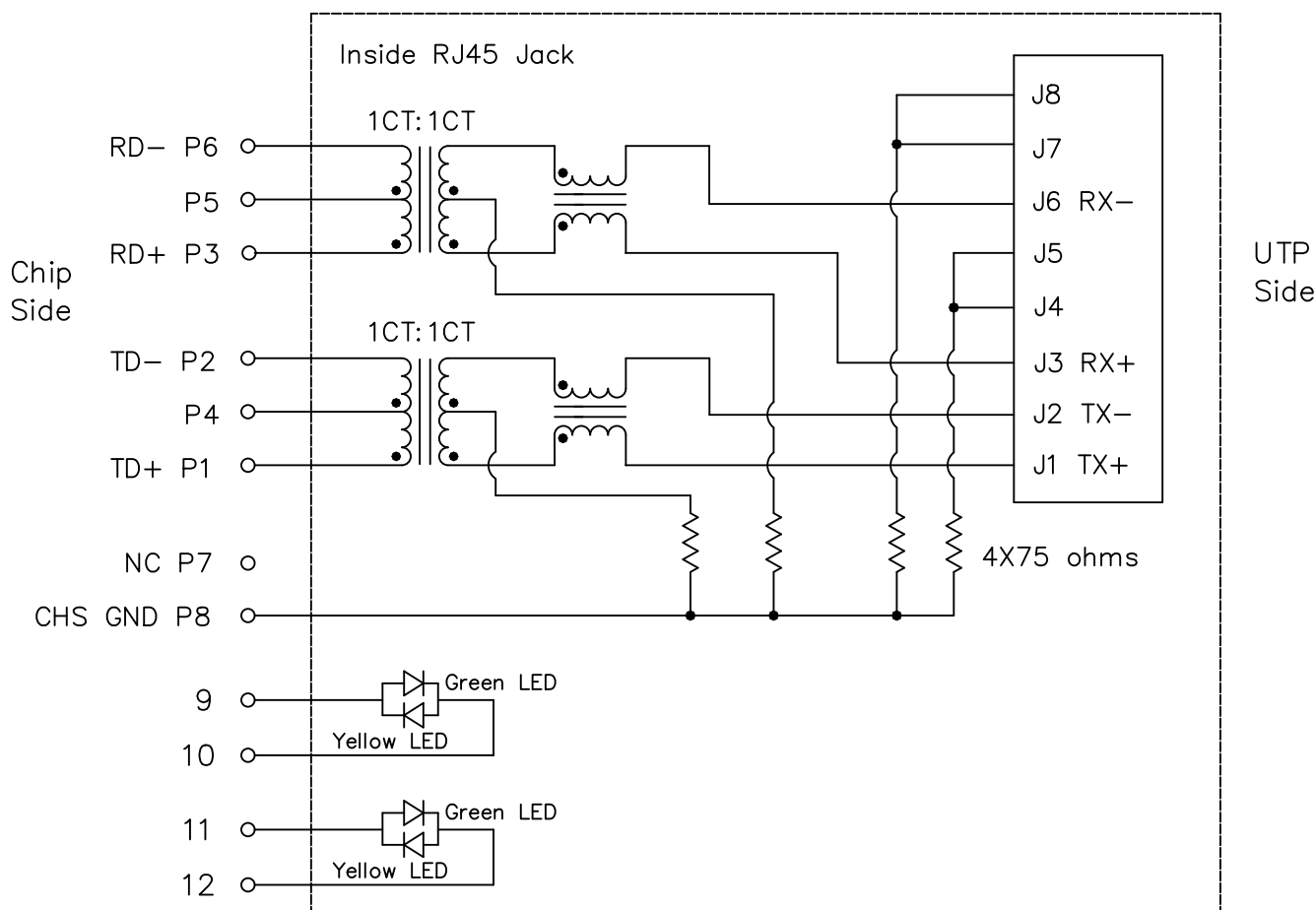

Notes: Connect CHS GND to PCB Ground

HR915592AE

- RoHS Compliant (PB Free)
- Meets or Exceeds IEEE802.3u standards including 350uH Min OCL with 8mADC
- High performance for EMI suppression, Crosstalk, Return Loss and Consistent Electrical
- Minimum 2250VDC isolation per IEEE802.3 requirement
- Minimize PCB space and Simplify PCB Layout
- Less magnetic components to be placed on PCB, higher reliability and yields
- UL Recognized Component: File # E330599

Mechanical Dimensions:

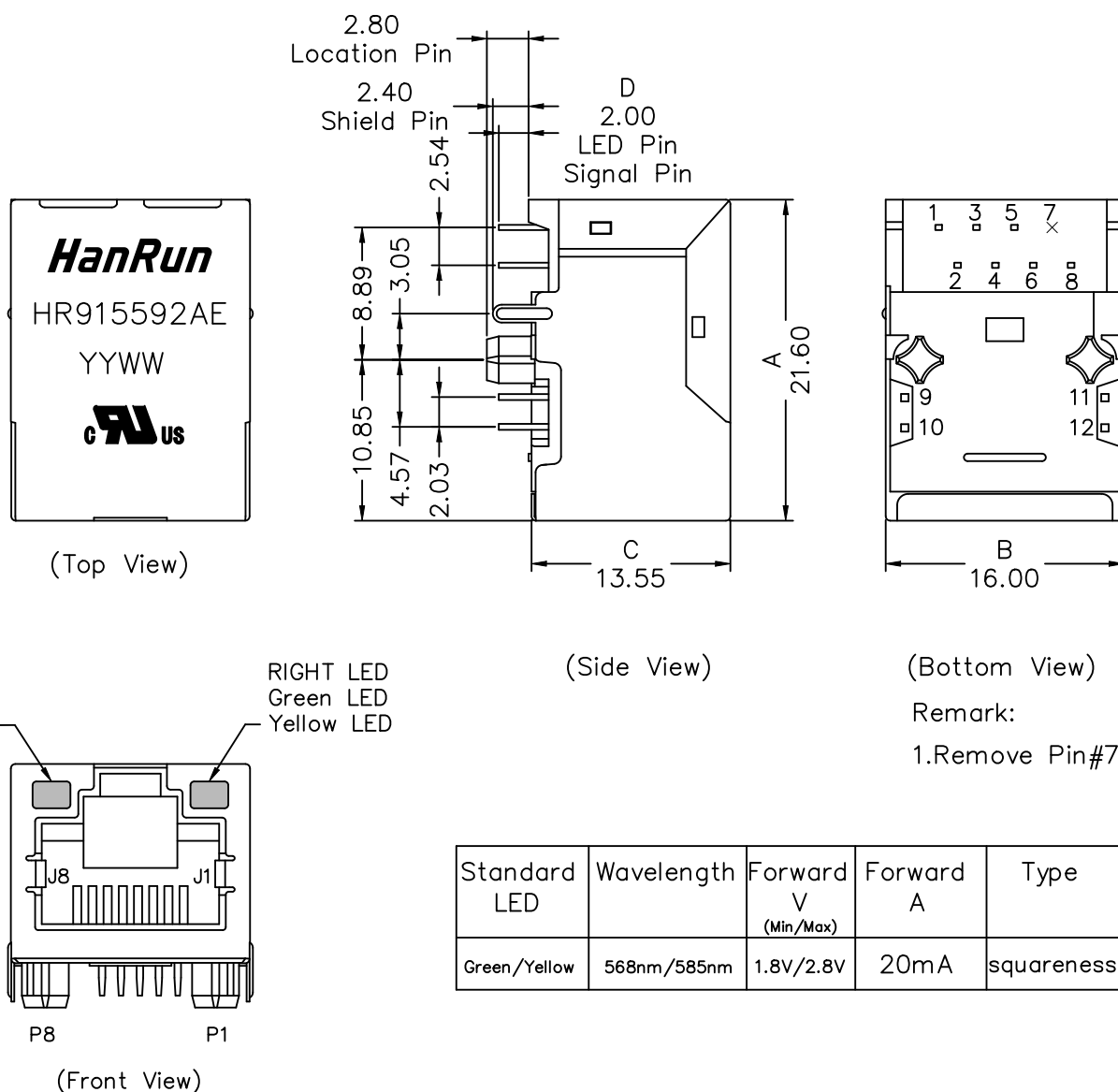

Dimensions in mm

Unless otherwise specified, Tolerance: .xx ±0.25

REV.: A1

2 of 5

DRAWN:

CHECK:

APPROVAL:

Tel: (0760)86103511 86103508 Fax: (0760)86103686 Post code: 528416

E-Mail: sales@hanrun.com http://www.hanrun.com

HR915592AE

PCB Layout:

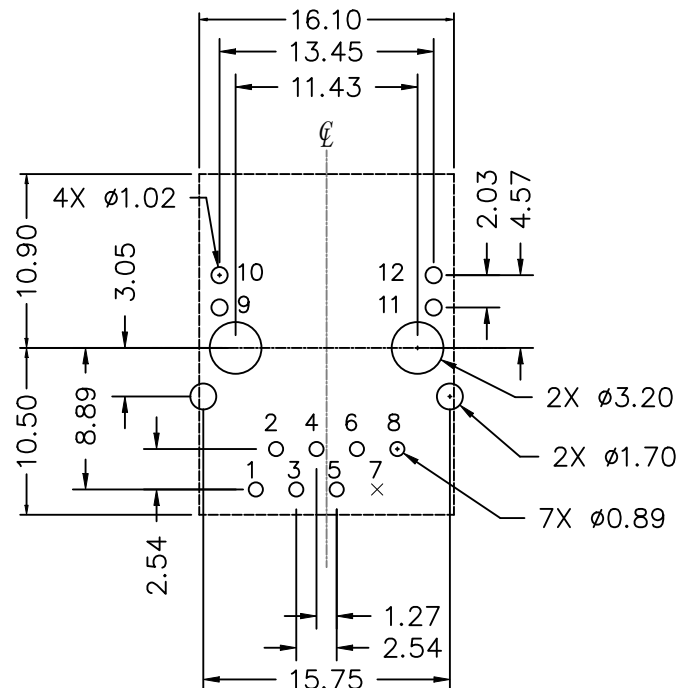

Recommended PCB layout (Component Side View)

All dimension tolerance are ± 0.08 unless otherwise specified

Suggested Panel Cutout:

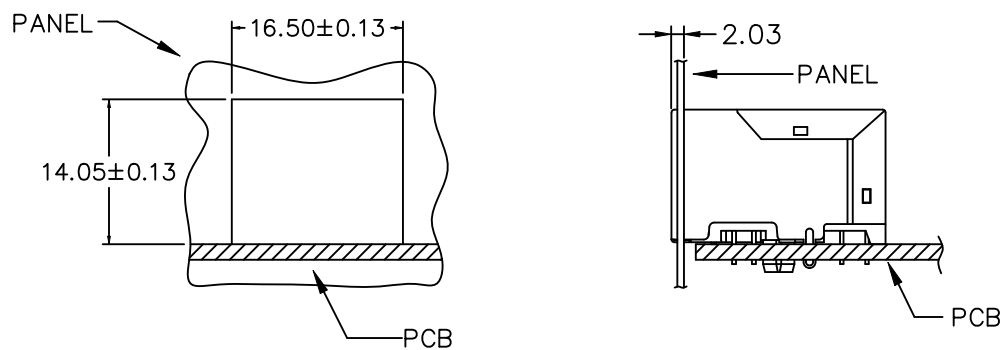

SUGGESTED PANEL OPENING

Dimensions in mm

Unless otherwise specified, Tolerance: .xx ± 0.25

REV.: A1

3 of 5

DRAWN:

CHECK:

APPROVAL:

Tel: (0760)86103511 86103508 Fax: (0760)86103686 Post code: 528416

E-Mail: sales@hanrun.com <http://www.hanrun.com>

1x1 Port Tab-UP RJ45 Connector
with Integrated Magnetics and LED
Is suitable for reflow solder mounting

HR915592AE

Material Specification:

Housing: PA9T Black UL94V-0
Shield: 50u" Nickel over 0.20mm Thickness Brass
Insert: PA9T Black UL94V-0
Phosphor Bronze 0.35mm Thickness
Plating Area, 30u" gold over 50u" nickel
Solder Area, 100u" tin over 50u" nickel

Mechanical Performance:

Mating force: 5 lbs Maximum
Unmating force: 5 lbs Maximum
Operating life: 750 Cycles Minimum

Operating and Storage Temperature:

Operating Temperature Range: -40°C ~ +85°C
Storage Temperature Range: -40°C ~ +85°C

HR915592AE

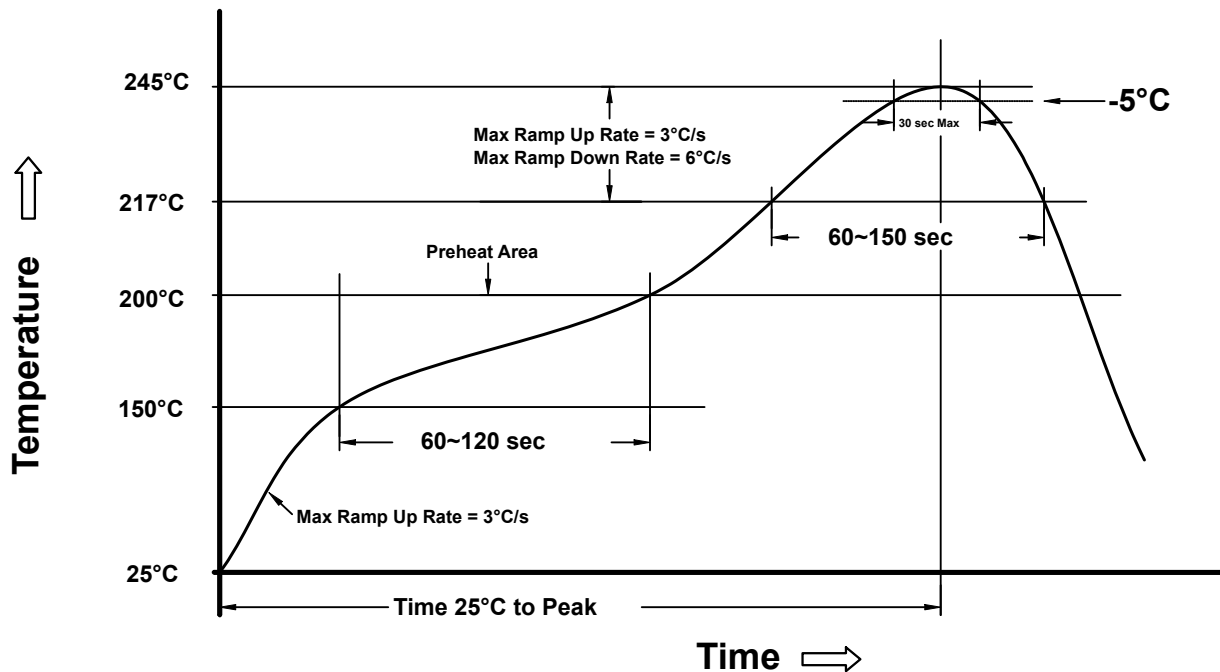

Remarks:

- peak temperature = 245°C
- Maximum preheat rate = 3°C / sec
- Ramp up rate = 3°C / sec max
- Time above 217°C = 60 sec min / 150 sec max
- Maximum cooling rate = 6°C / sec
- T 25°C to peak = 8 min max
- preheat Time = 60 ~ 120 sec
- The number of allowed cycles in IR reflow ≤ 2 cycles