

## HR872192H

### Electrical Specification @25°C

RoHS Compliant (PB Free)

Isolation: 2250VDC 0.5mA 60sec (UTP Side to Chip Side)

OCL: 180uH Minimum @100KHz 100mV with 8mADC

Insertion Loss: -1.0dB Maximum @300KHz ~ 100MHz / -1.25 Maximum @100MHz ~ 250MHz

Return Loss: -20dB Minimum @1MHz ~ 40MHz / -18dB Minimum @40MHz ~ 60MHz

-16dB Minimum @60MHz ~ 80MHz / -14dB Minimum @80MHz ~ 100MHz

-12dB Minimum @100MHz ~ 150MHz / -9dB Minimum @150MHz ~ 250MHz

Common to Differential Mode Rejection: -30dB Minimum 1MHz ~ 250MHz

Crosstalk: -30dB Minimum 1MHz ~ 100MHz / -25dB Minimum 100MHz ~ 250MHz

### Schematics

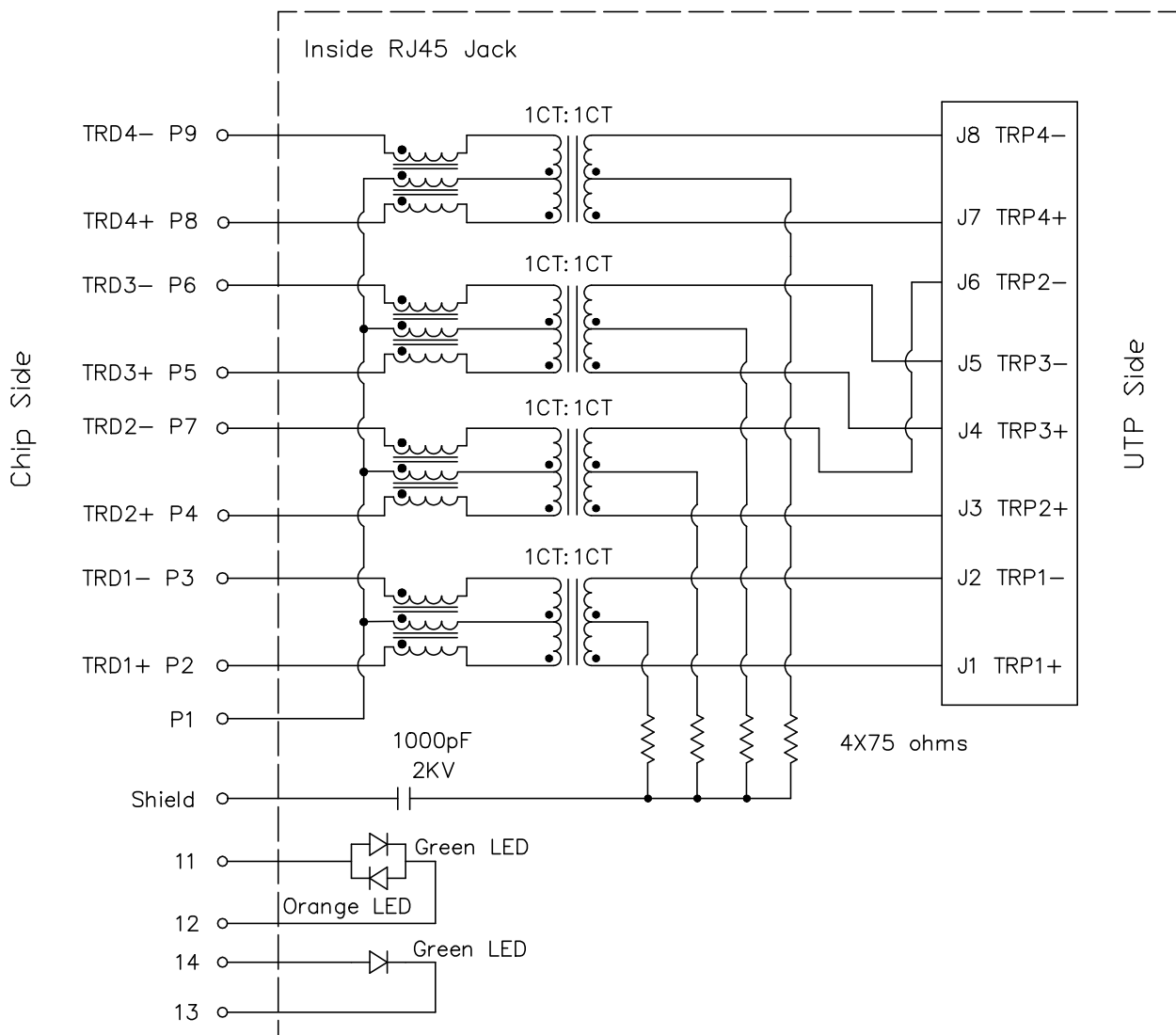

## HR872192H

### Commercial standards, specifications and Summary:

RoHS Compliant (Pb Free)

Meets or Exceeds IEEE802.3bz standards

High performance for EMI suppression, Crosstalk, Return Loss and Consistent Electrical

Minimum 2250VDC isolation per IEEE802.3 requirement

Minimize PCB space and Simplify PCB Layout

Less magnetic components to place on PCB, Higher reliability and yields

UL Recognized Component: File # E330599

### Material Specification:

Housing: PBT GF Black UL94V-0

Shield: 50u" Nickel over 0.20mm Thickness Brass

Insert: PA66 GF Black UL94V-0

Phosphor Bronze 0.35mm Thickness

Plating Area, 30u" gold over 50u" nickel

Solder Area, 100u" tin over 50u" nickel

RJ45 Contact pin: PA66 GF Black UL94V-0

Brass; 100u" Tinning

LED Conductor: PC Transparent UL94V-0

### Mechanical Performance:

Contact resistance: 30 mΩ Maximum

Mating force: 5 lbs Maximum

Unmating force: 5 lbs Maximum

Operating life: 750 Cycles Minimum

### Operating and Storage Temperature:

Operating Temperature Range: 0°C ~ +70°C

Storage Temperature Range: -40°C ~ +85°C

## HR872192H

### Mechanical Dimensions:

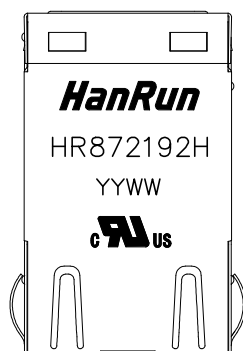

(Top View)

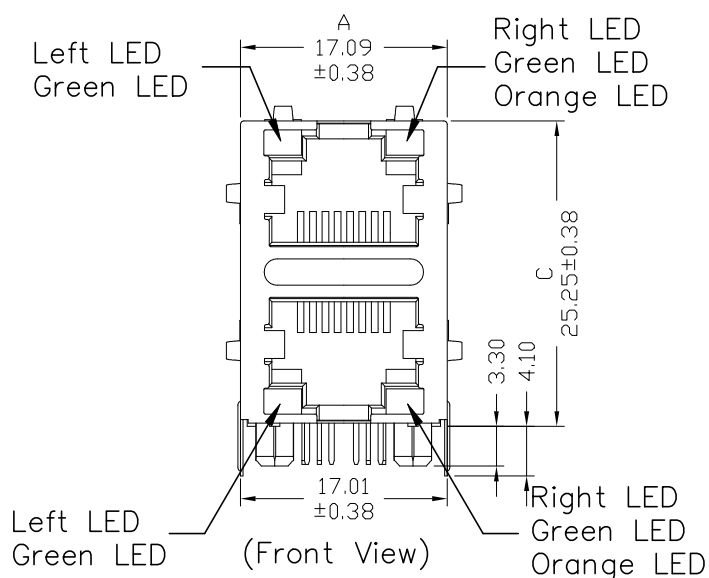

(Front View)

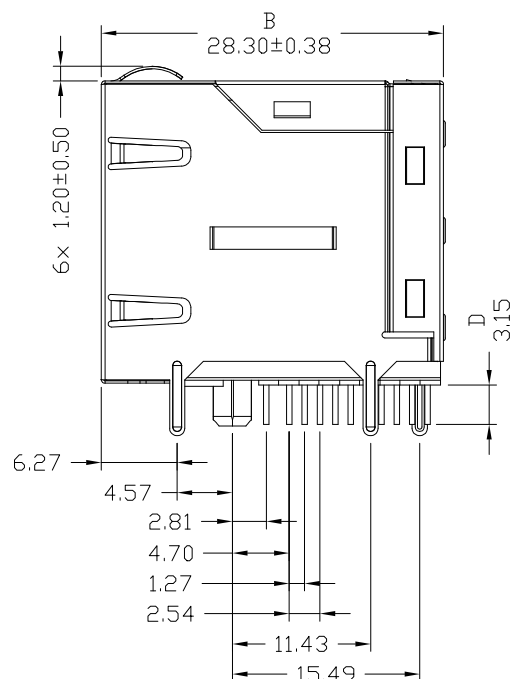

(Side View)

Standard LED	Wavelength	Forward V (Min/Max)	Forward A	Type
Green	568nm	1.8V/2.8V	20mA	squareness
Green/Orange	568nm/600nm	1.8V/2.8V	20mA	squareness

Dimensions in mm

Unless otherwise specified, Tolerance: .xx ±0.25

REV.: 00

3 of 5

HR872192H

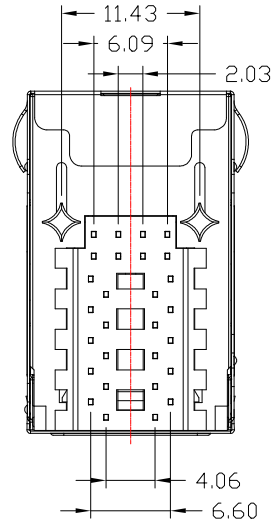

(Bottom View)

Suggested Panel Cutout:

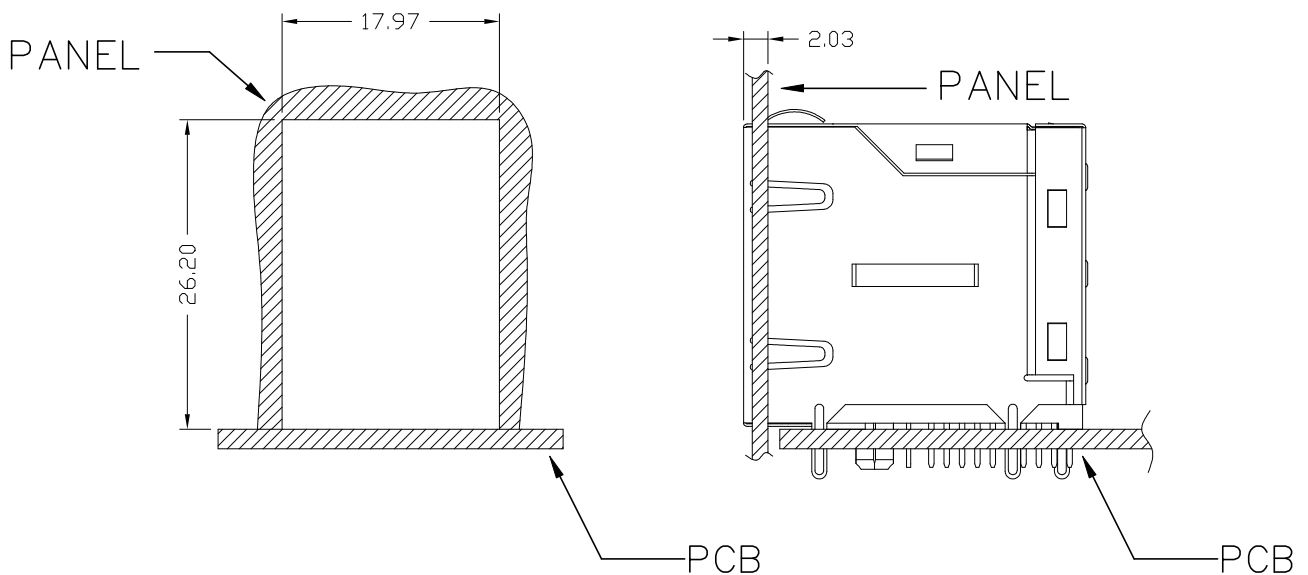

SUGGESTED PANEL CUTOUT

Dimensions in mm

Unless otherwise specified, Tolerance: .xx ±0.25

REV.: 00

4 of 5

## HR872192H

### PCB Layout:

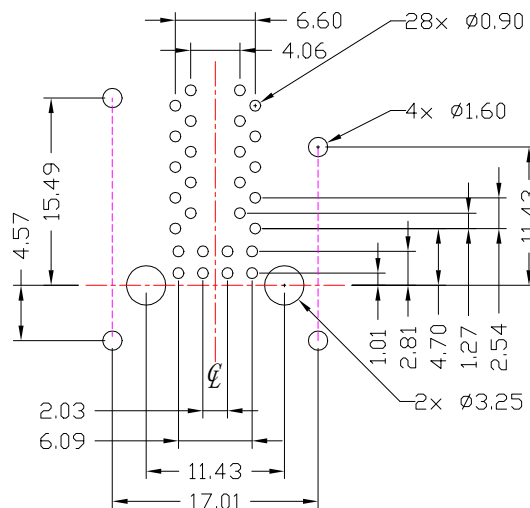

(Recommended PCB layout)

All dimension tolerance are  $\pm 0.08$  unless otherwise specified

### Pin Assignments:

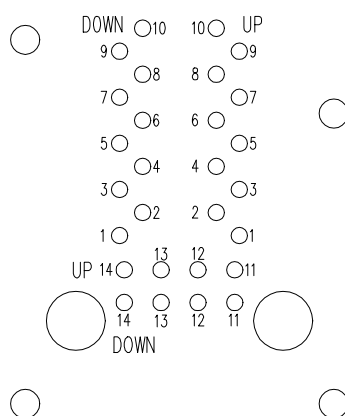

Dimensions in mm

Unless otherwise specified, Tolerance: .xx  $\pm 0.25$

REV.: 00

5 of 5